

2

1

Installation Manual



Accessories

Local Products

Modular Hood

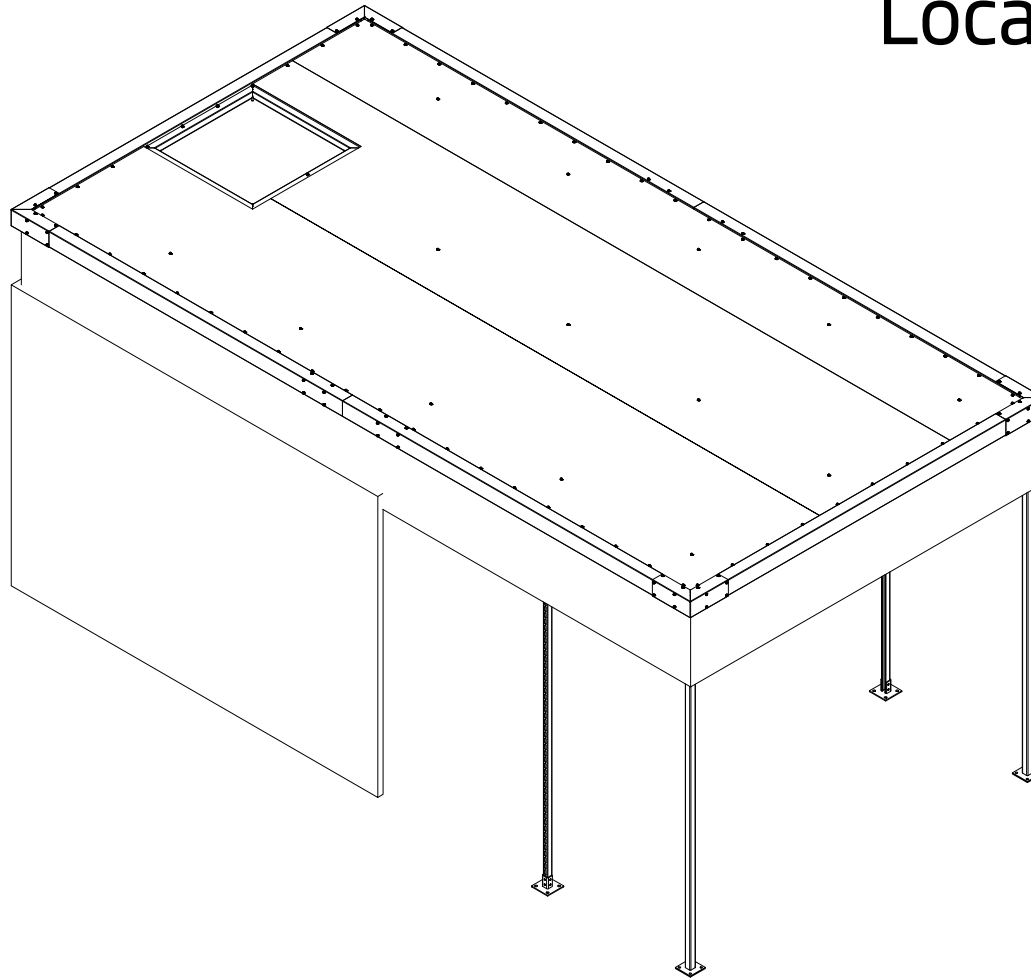

REV.10823



TABLE OF CONTENTS

TABLE OF CONTENTS 2
HOOD OVERVIEW 3
HOOD MOUNTING OPTIONS 5
HOOD ASSEMBLY INSTRUCTIONS 6
CORNER INSTALL INSTRUCTIONS 12
HOOD COMPONENTS 13
BEST PRACTICES 19

<i>NEDERMAN</i>			
<i>TITLE</i> <i>MODULAR HOOD INSTALL INSTRUCTIONS</i>			
<i>SIZE</i> A		<i>DWG NO</i> MH_Install Guide	<i>REV</i> 2
<i>SCALE</i>			<i>SHEET 2 OF 20</i>

HOOD OVERVIEW

UNI-STRUT WITH FOOTPADS
OR PART NUMBER SP-2-2-120

NOTE:
USE THIS AS A REFERENCE FOR STANDARD FASCIA HOOD INSTALLS.

TOTAL HARDWARE, FASCIA PANEL, POLY GAL QUANTITIES
AND CURTAIN LENGTH WILL DEPEND ON HOOD SIZE.

FIGURE (12) SCREWS PER CORNER PIECE (1) SCREW PER (1) FOOT OF
POLY GAL (1) SCREW PER (1) FOOT OF CURTAIN (2) SCREWS PER
UNISTRUT TO FASTEN TO FASCIA AND ~ (3) POINTS PER UNISTRUT
TO FASTEN TO ROBOT FENCING.

NEDERMAN			
TITLE			
MODULAR HOOD INSTALL INSTRUCTIONS			
SIZE		DWG NO	REV
A		MH_Install Guide	2
SCALE	1 / 45	SHEET 3 OF 20	

HOOD OVERVIEW

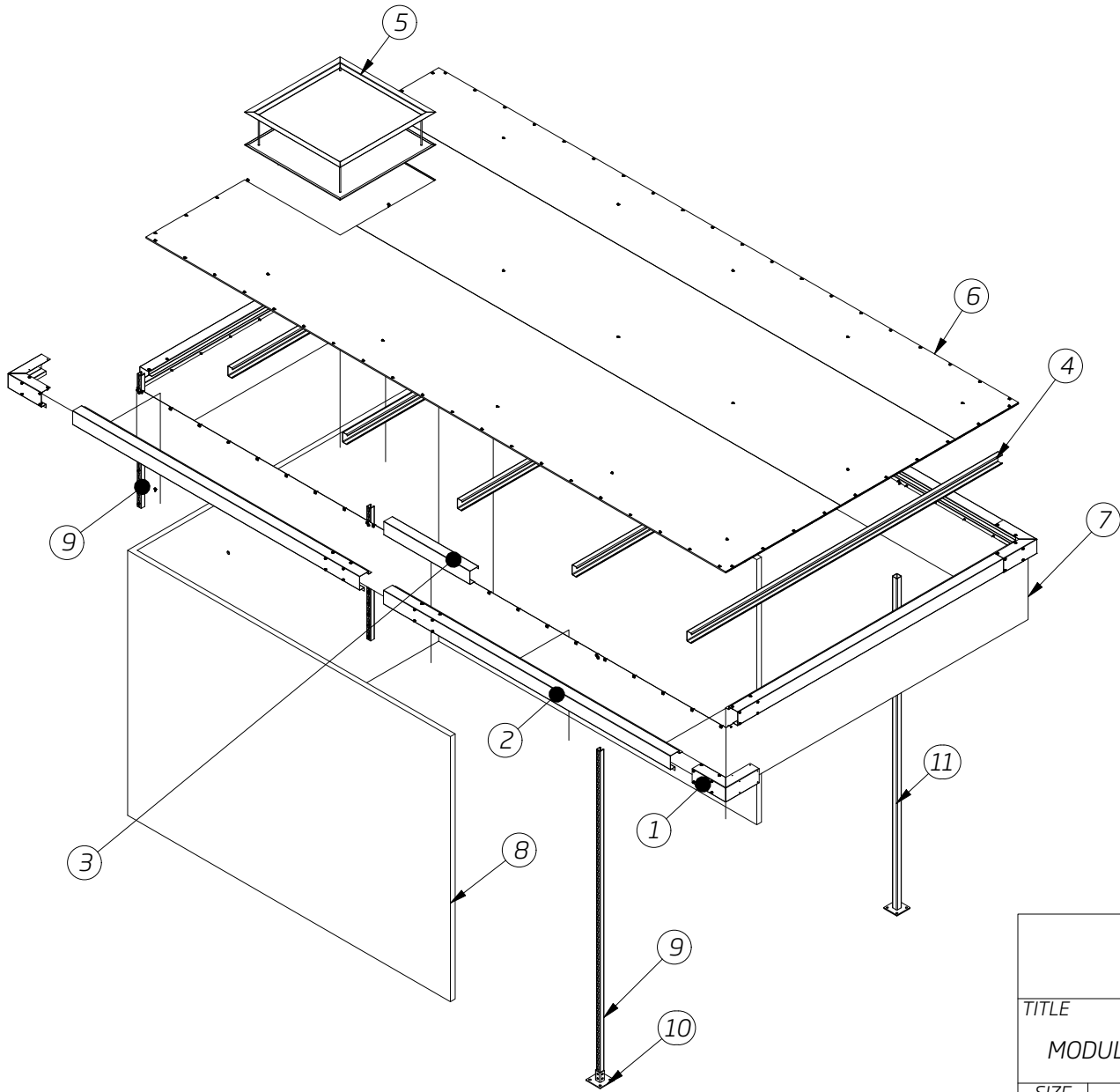

Parts List			
ITEM	QTY	MODEL NUMBER	DESCRIPTION
1	4	CPS-6-14-HS30	CORNER PANEL
2	6	FPS-6-120-HS10	FASCIA PANEL -10'
3	2	jps-6-36-HS20	JOINER PANEL
4	5	SR-23-288	SUPPORT RIB - 24'
5	1	BK-2424-BLANK	BAFFLE KIT (MAX DUCT DIA 20")
6	3	PG-48-488	POLYGAL 48"X24'
7	1	WC40-48-150	WELD CURTAIN 48"X150'/ROLL
8	1	MH-Cell_REF-0 2-001	CELL FENCE LINE REFERENCE
9	6	GLP-2000-T	UNISTRUT - 20'
10	2	GLP-2072-A	UNISTRUT FOOT PADS
11	1	SP-2-2-120	SUPPORT POST WITH FOOTPAD

NEDERMAN

TITLE			
MODULAR HOOD INSTALL INSTRUCTIONS			
SIZE	DWG NO	REV	
A	MH_Install Guide	2	
SCALE	SHEET 4 OF 20		
1 / 50			

MOUNTING OPTIONS

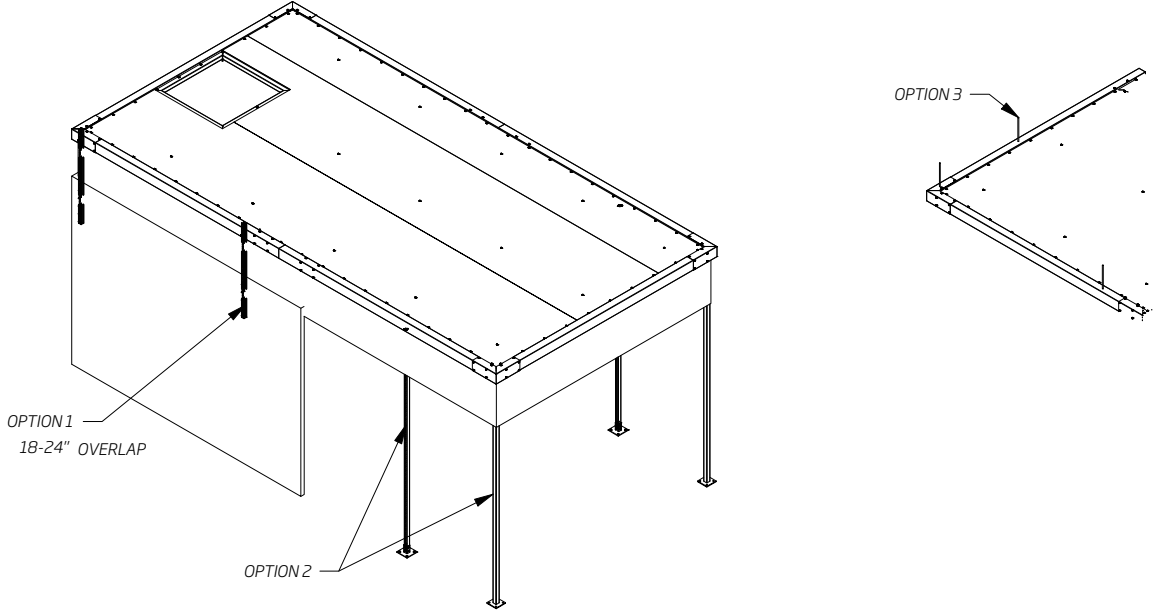

OPTION 1:
 SUPPORT THE HOOD BY BOLTING THE UNISTRUT CHANNELS TO THE INSIDE FACE OF THE CELL FENCE POSTS

OPTION 2:
 INSTALL THE HOOD FREE STANDING FROM THE CELL FENCE POSTS BY RUNNING THE UNISTRUT CHANNEL WITH FOOTPADS FROM THE HOOD TO THE FLOOR OR USE ROBOVENT PART NUMBER SP-2-2-120 IN LEU OF THE UNI-STRUT AND FOOTPAD.

OPTION 3 (CUSTOM):
 SUSPEND FROM CEILING TRUSS WITH THREADED ROD AND CHANNEL.

ALL MOUNTING OPTIONS REQUIRE SUPPORT POST/STRUT CHANNEL/ EXTENSION POST TO BE CUT TO LENGTH PER MOUNTING INSTRUCTIONS SECTION.

HOOD INCLUDES STANDARD HARDWARE KIT SHIPPED IN A SMALL BOX.

NEDERMAN			
TITLE MODULAR HOOD INSTALL INSTRUCTIONS			
SIZE A	DWG NO MH_Install Guide		REV 2
SCALE 1 / 80			SHEET 5 OF 20

INSTALLATION: FASCIA ASSEMBLY

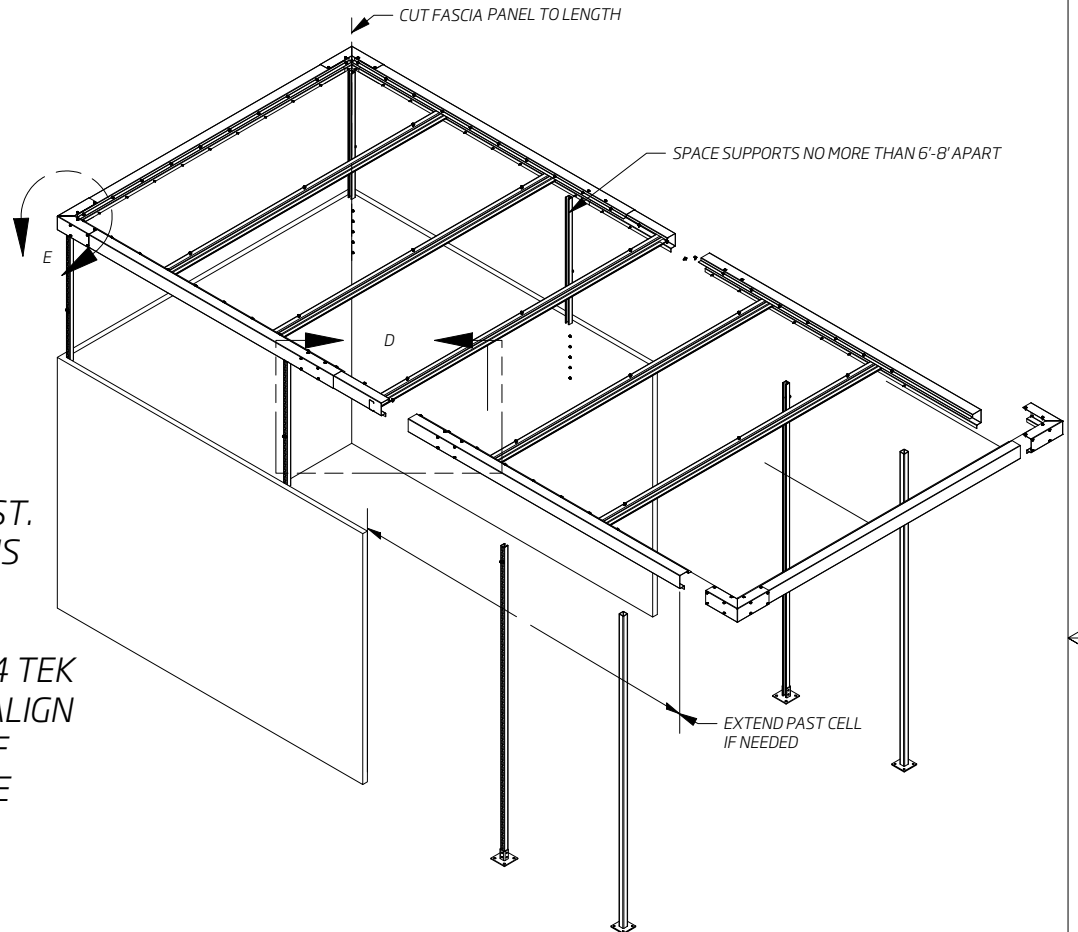

1. CUT MOUNTING POSTS TO LENGTH REQUIRED BY HOOD HEIGHT. VERIFY THE MAX ROBOT TRAVEL HEIGHT WHEN DETERMINING THE HOOD HEIGHT.

2. BUILD THE REAR FASCIA ASSEMBLY WITH CORNERS FIRST. ATTACH POSTS ALONG THE ADJOINING SIDES. HARDWARE IS INCLUDED IN KIT.

3. ASSEMBLE CORNER PANELS TO FASCIA PANEL WITH #14 TEK SCREWS. SEE INSET "CORNER ASSEMBLY"; MAKE SURE TO ALIGN END OF FASCIA FLUSH WITH THE PERPENDICULAR EDGE OF CORNER. SET THIS INTO THE MOUNTING POSTS ALONG ONE SIDE. FASCIA CAN ALSO BE BUTTED UP TO INSIDE EDGE OF BOTTOM LIP. OTHER SIDE WILL STILL BE 3" FROM CORNER.

4. SET ONE FASCIA PANEL ON TOP OF POSTS ON THE ADJACENT SIDE. FASTEN THESE TOGETHER AT THE CORNER WITH #14 TEK SCREWS AND SECURE TO THE SUPPORTS.

5. ASSEMBLE AROUND THE CELL, WORKING TOWARDS THE OPERATOR AREA. USE JOINER PANELS INSERTED INSIDE FASCIA TO CONNECT. ASSEMBLE JOINER TO ONE FASCIA PRIOR TO SETTING ON SUPPORTS. ONLY FACTORY CUT EDGES TO BE USED AT JOINER SEAMS.

<h1>NEDERMAN</h1>			
TITLE			
MODULAR HOOD INSTALL INSTRUCTIONS			
SIZE		DWG NO	REV
A		MH_Install Guide	2
SCALE	1/60	SHEET 6 OF 20	

2

1

INSTALLATION: FASCIA ASSEMBLY CONT.

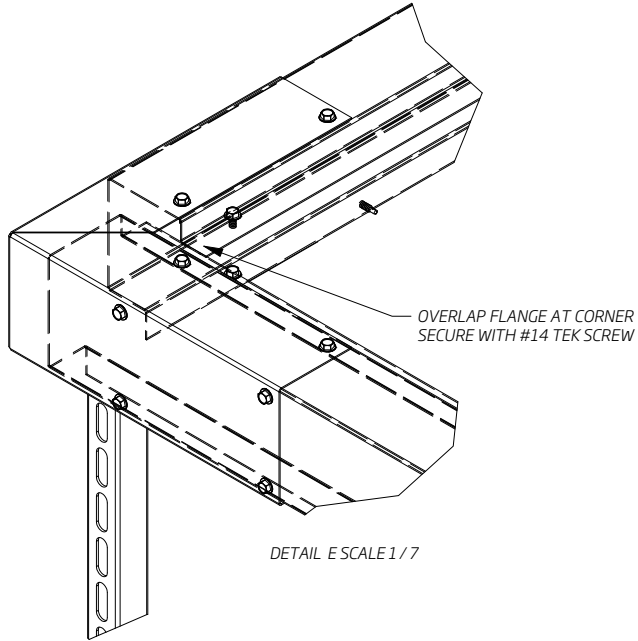

OVERLAP FLANGE AT CORNER
SECURE WITH #14 TEK SCREW

DETAIL E SCALE 1/7

CORNER ASSEMBLY

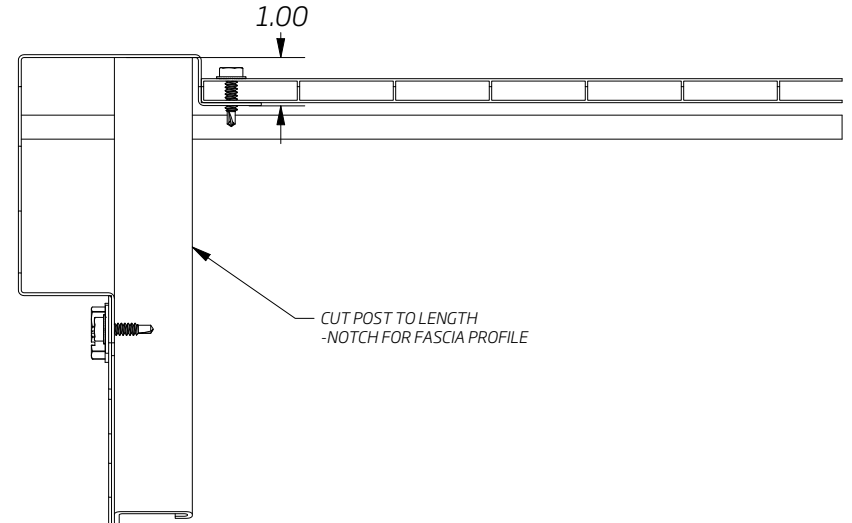

1.00

CUT POST TO LENGTH
-NOTCH FOR FASCIA PROFILE

SUPPORT ASSEMBLY

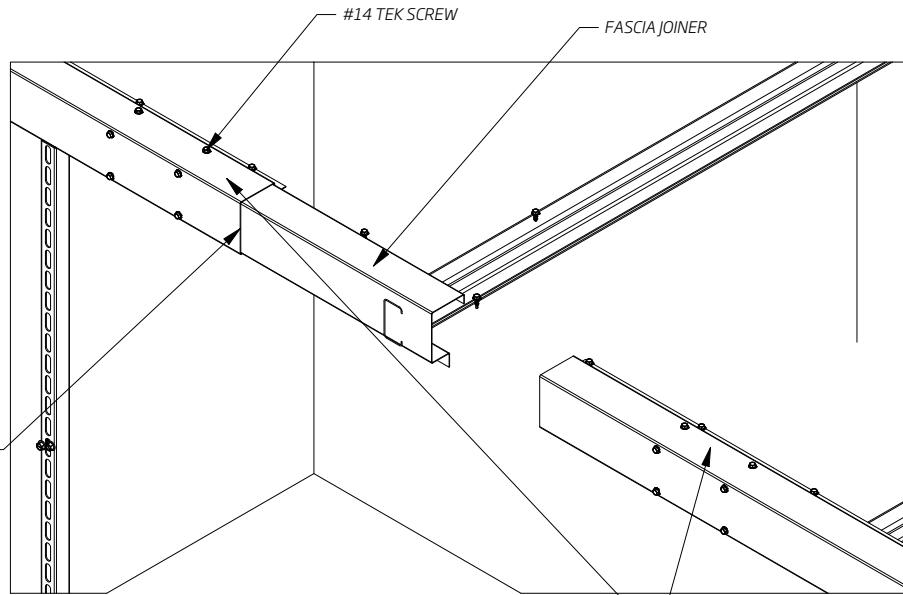

#14 TEK SCREW

FASCIA JOINER

DETAIL D SCALE 1/15

JOINER ASSEMBLY

FASCIA PANEL

THE FASCIA EDGES THAT WILL
BUTT TOGETHER MUST BOTH
BE FACTORY EDGES, NOT CUT
EDGES

NEDERMAN

TITLE

MODULAR HOOD INSTALL INSTRUCTIONS

SIZE
A

DWG NO

MH_Install Guide

REV
2

SCALE
1/7

SHEET 7 OF 20

2

1

INSTALLATION: INTAKE, POLYGAL AND CURTAIN ASSEMBLY

1. THE BAFFLE KIT INTAKE IS NORMALLY INSTALLED AT THE BACK OF THE CELL, CENTERED SIDE-TO-SIDE AND IS TYPICALLY SUPPORTED BETWEEN THE FASCIA LIP AND THE SUPPORT RIB OR IT IS SUPPORTED BETWEEN TWO SUPPORT RIBS. REFERENCE THE PROJECT SPECIFIC DRAWING FOR BAFFLE KIT LOCATION.
2. SECURE SUPPORT RIBS WITH #14 TEK SCREWS AT EACH END SPACED SO THE FLANGES OF THE INTAKE REST ON TOP OF THE SUPPORT RIBS. THE BAFFLE KIT SHOULD BE CUT OUT AND ASSEMBLED PRIOR TO SECURING TO THE SUPPORT RIBS AND FASCIA.
3. SET INTAKE DEVICE BETWEEN THE SUPPORT RIB AND REAR FASCIA. SECURE WITH #14 TEK SCREWS. THE DEFLECTOR PLATE SHOULD BE INSTALLED 4"-6' BELOW THE TOP PLATE. THERE ARE PRE-DRILLED HOLES IN EACH CORNER OF THE DEFLECTOR PLATE AND TOP PLATE FOR THREADED ROD TO CONNECT THE TWO PARTS. THE DEFLECTOR PLATE AND THE 4X THREADED RODS CAN BE ASSEMBLED ON THE GROUND AND THEN LIFTED AND SECURED TO THE TOP PLATE WITH NUTS AND WASHERS.
4. THE HOLE FOR THE DUCTWORK IS CUT PER SIZE OF THE DUCT SPECIFIED. AN ANGLE FLANGE ADAPTER CAN BE USED TO CONNECT THE DUCTWORK TO THE TOP PLATE OF THE BAFFLE KIT.
5. INSTALL SUPPORT RIBS AND POLYGAL TO COVER TOP OF HOOD, BOTH MUST BE CUT TO SIZE. SECURE SUPPORT RIBS TO FASCIA WITH #14 TEK SCREWS AND POLYGAL TO SUPPORT RIBS TRIM POLYGAL AROUND INTAKE. SPACE SCREWS HOLDING POLYGAL, APPROX. 16".

NEDERMAN

TITLE

MODULAR HOOD INSTALL INSTRUCTIONS

SIZE
A

DWG NO

MH_Install Guide

REV
2

SCALE

SHEET 8 OF 20

2

1

INSTALLATION: INTAKE, POLYGAL AND CURTAIN ASSEMBLY CONT.

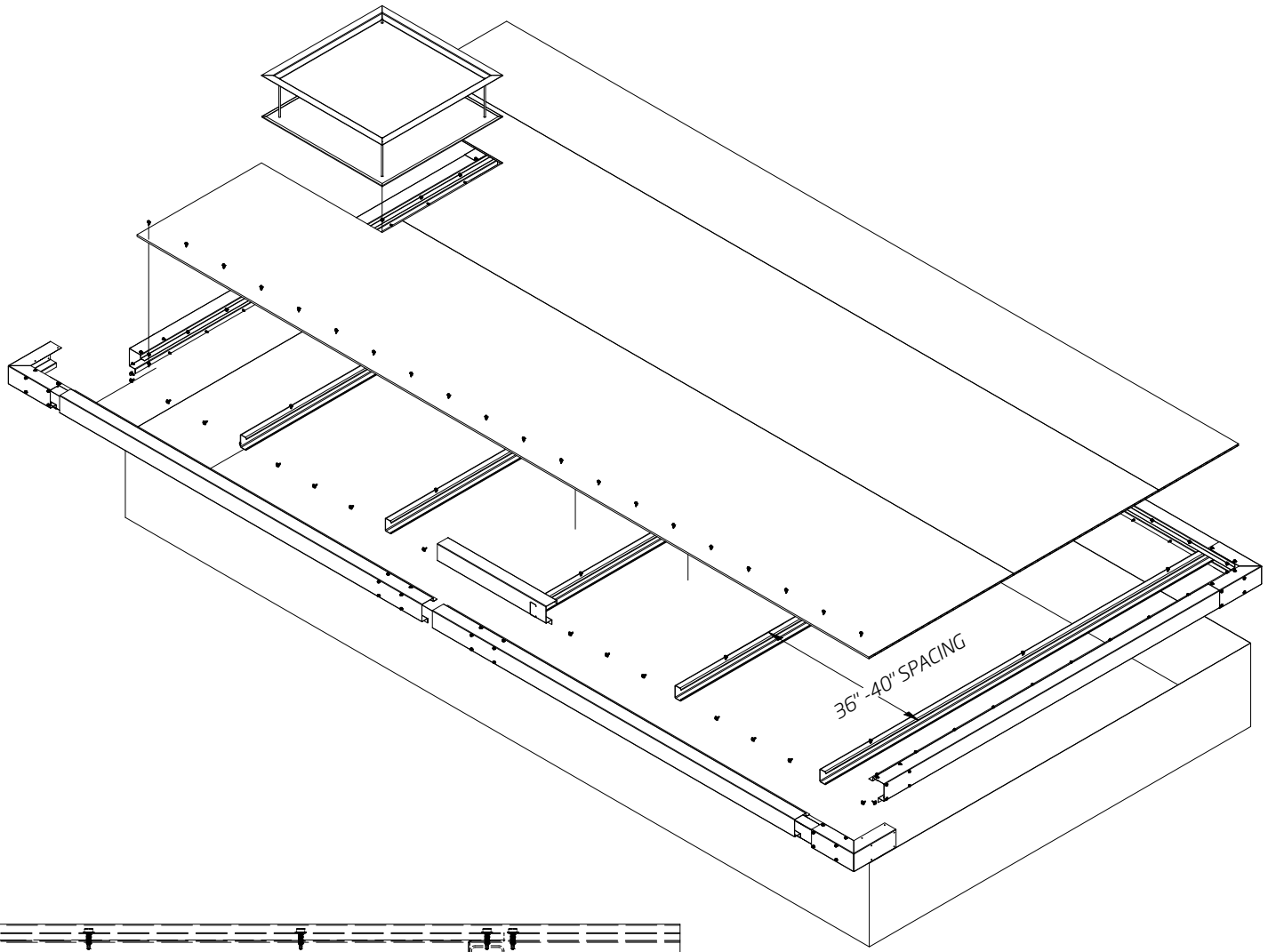

B

B

A

A

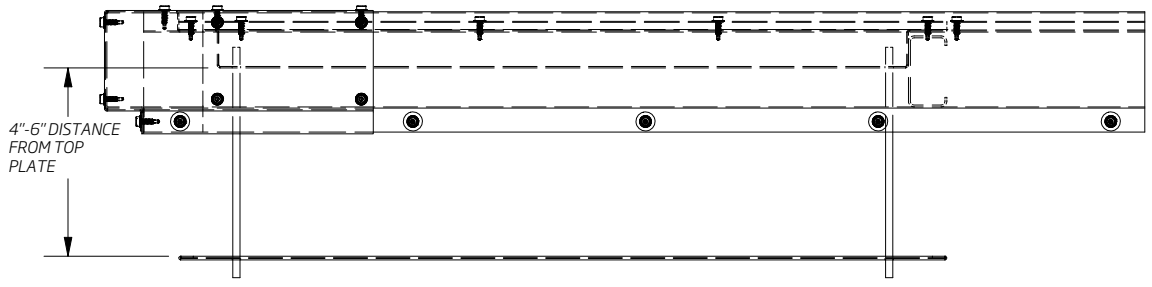

NEDERMAN

TITLE			
MODULAR HOOD INSTALL INSTRUCTIONS			
SIZE	DWG NO	REV	
A	MH_Install Guide	2	
SCALE	SHEET 9 OF 20		
1/10			

2

1



INSTALLATION: INTAKE, POLYGAL AND CURTAIN ASSEMBLY CONT.

6. USE CURTAIN TO ENCLOSE THE SPACE BETWEEN THE HOOD AND CELL. USE A 4" MINIMUM CURTAIN OVERLAP CURTAIN OF CELL GUARDING 4" MINIMUM AND 4-6" OVERLAP OF VERTICAL SEAMS TO ENSURE THERE ARE NO GAPS. ATTACH TO BOTTOM FLANGE OF FASCIA WITH #14 TEK SCREWS AND FENDER WASHERS, APPROX. EVERY 12". LEAVE BOTTOM OF CURTAIN UNFASTENED AND ENSURE THE CURTAIN IS HANGING ON THE INSIDE OF THE CELL FENCE LINE SO IT HAS A CLEAN AND PROFESSIONAL APPEARANCE FROM THE OUTSIDE.

***NOTE: IN ORDER FOR THE CURTAIN TO HANG ON THE INSIDE OF THE CELL AND HANG FREELY WITH NO WRINKLES OR CREASES, OBSTRUCTIONS SUCH AS CABLE TRAYS, WELD WIRE FEEDERS, ADDITIONAL SUPPORTS ETC., MUST BE NOTCHED AROUND CAREFULLY TO KEEP A PROFESSIONAL CLEAN LOOK AND TO ENSURE CURTAIN GAPS ARE KEPT TO A MINIMUM.**

OPTIONAL: IF THERE IS A ROTATING TABLE IN USE, A SUPPORT RIB CAN BE INSTALLED ABOVE THE DIVIDER AND CURTAIN CAN BE HUNG FROM THIS SUPPORT RIB TO ENCLOSE THE SPACE ABOVE THE DIVIDER.

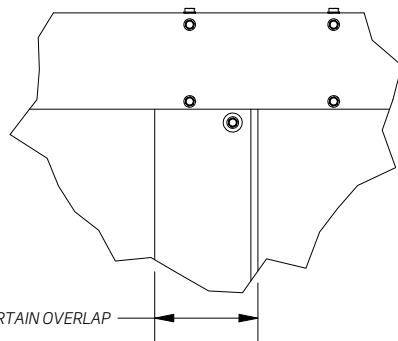
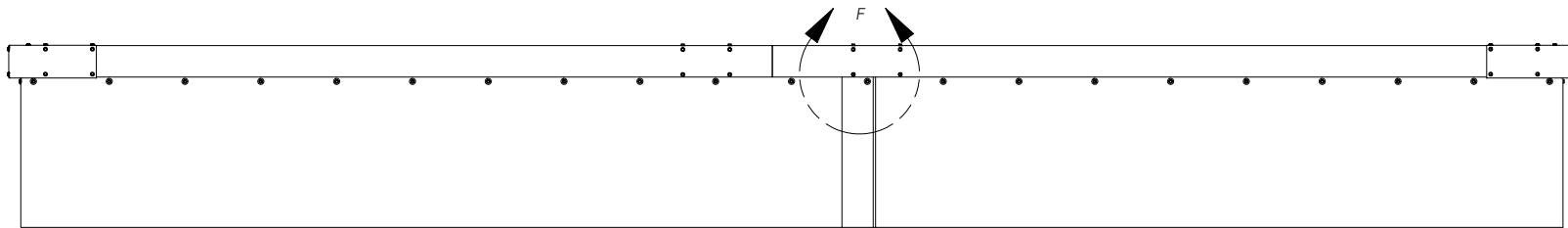

4-6" CURTAIN OVERLAP

DETAIL F SCALE 1/10

<h1>NEDERMAN</h1>			
TITLE MODULAR HOOD INSTALL INSTRUCTIONS			
SIZE A		DWG NO MH_Install Guide	REV 2
SCALE 1/30		SHEET 10 OF 20	



2

1

INSTALLATION: INTAKE, POLYGAL AND CURTAIN ASSEMBLY CONT.

NEDERMAN LOGO DECALS
AND "DANGER: DO NOT STAND ON THIS HOOD SURFACE"
STICKERS TO BE INSTALLED ON ALL FOUR SIDES OF FASCIA.

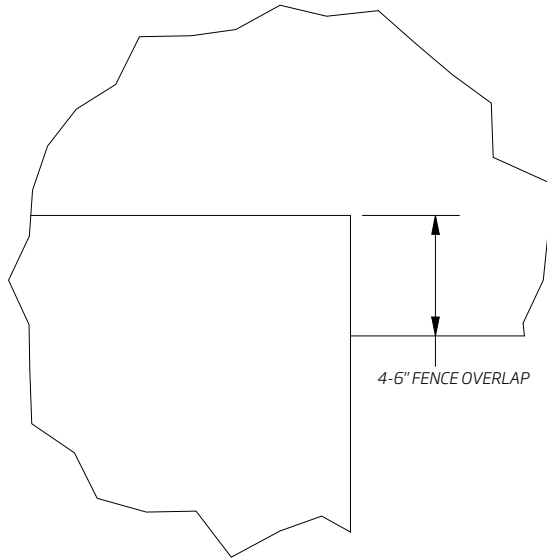
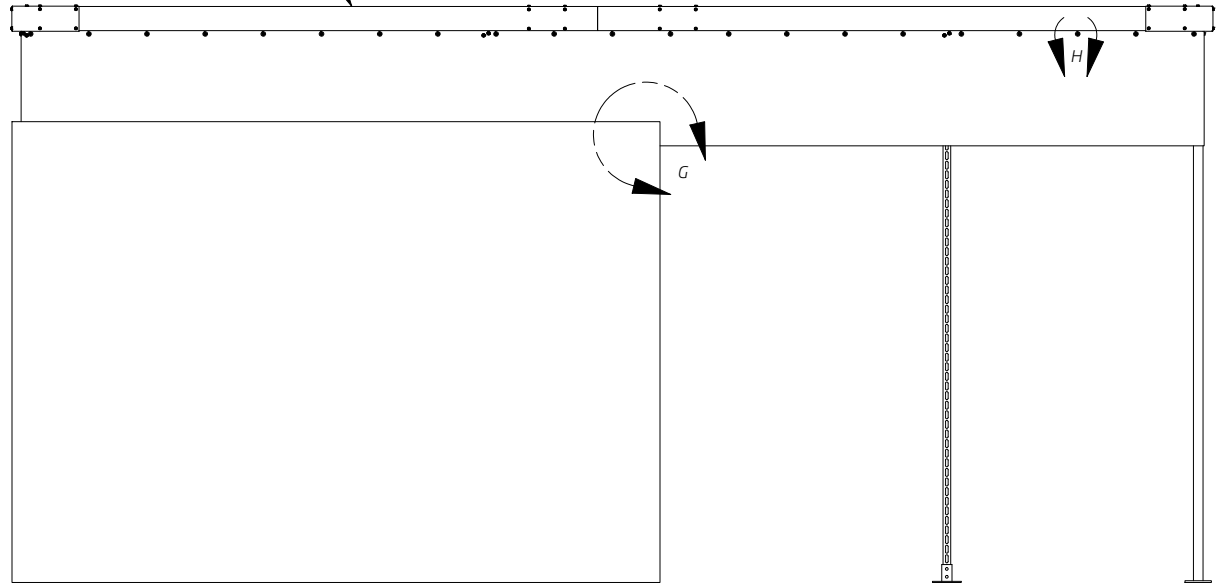

DETAIL G SCALE 1/8

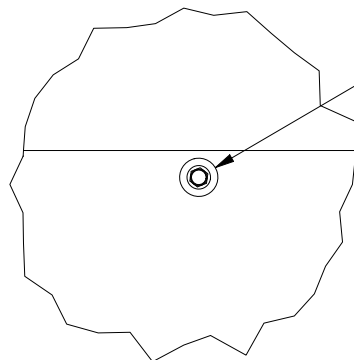

DETAIL H SCALE 1/5

FENDER WASHER AND TEK SCREW
FASTENER FOR CURTAIN

NEDERMAN

TITLE

MODULAR HOOD INSTALL INSTRUCTIONS

SIZE

A

DWG NO

MH_Install Guide

REV

2

SCALE

1/8

SHEET 11 OF 20

2

1

HOOD CORNERS

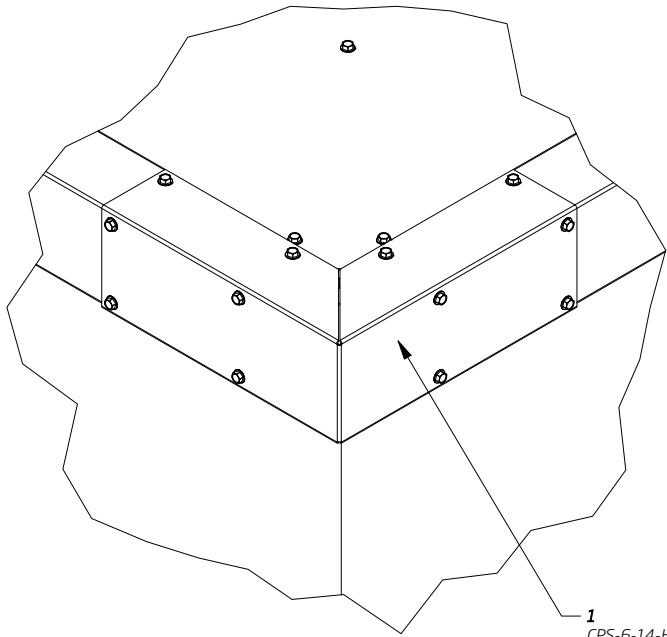

1
CPS-6-14-HS30

DETAIL | SCALE 1/8

MITER CUT FASCIA SECTIONS SO
THEY JOIN TOGETHER UNDER
THE INSIDE CORNER PIECE

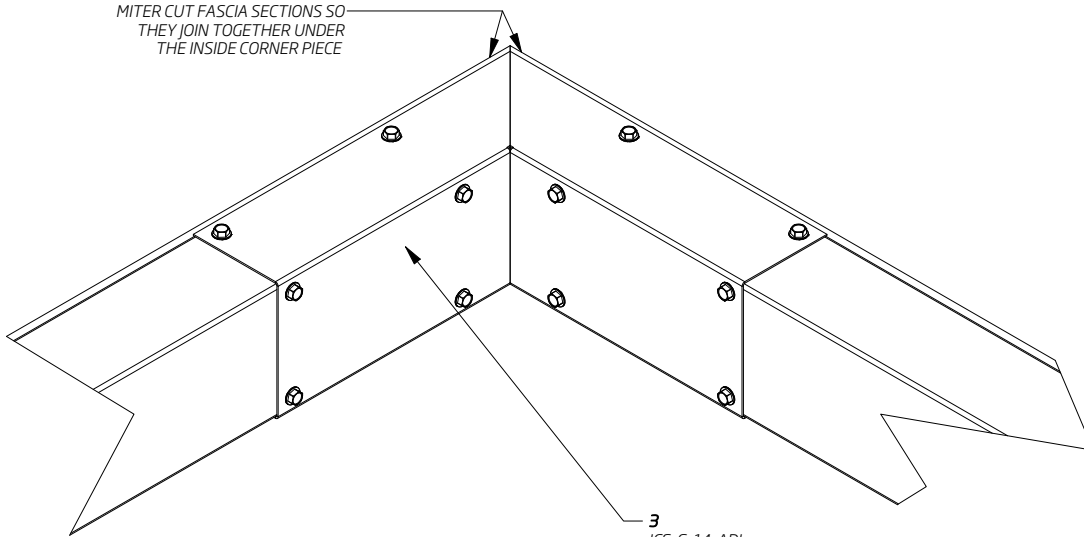

3
ICS-6-14-ADJ

SCALE 1/6

<h1>NEDERMAN</h1>			
TITLE MODULAR HOOD INSTALL INSTRUCTIONS			
SIZE A		DWG NO MH_Install Guide	REV 2
SCALE 1/10		SHEET 12 OF 20	

HOOD COMPONENTS

BK-2424-BLANK

BAFFLE KIT

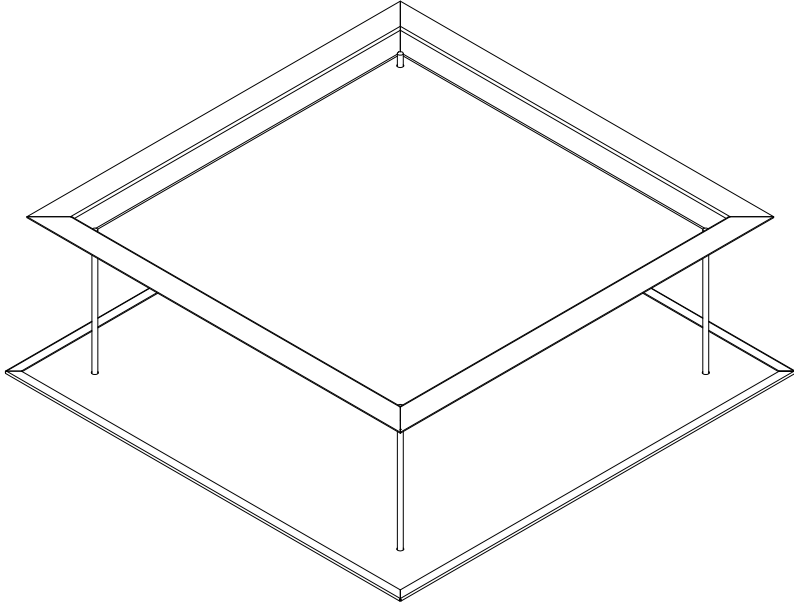
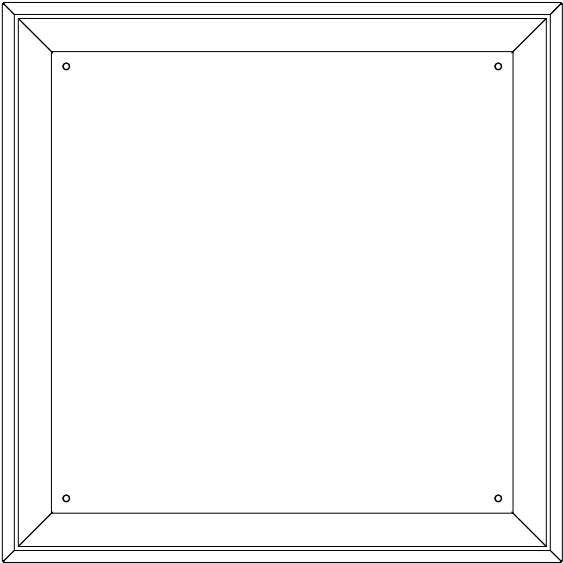

BK-2424-BLANK
SCALE 1/12

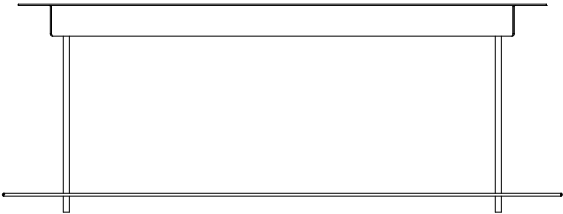

NEDERMAN

TITLE			
MODULAR HOOD INSTALL INSTRUCTIONS			
SIZE		DWG NO	REV
A		MH_Install Guide	2
SCALE	1/12	SHEET 13 OF 20	

HOOD COMPONENTS CONT.

CPS-6-14

CORNER PANEL

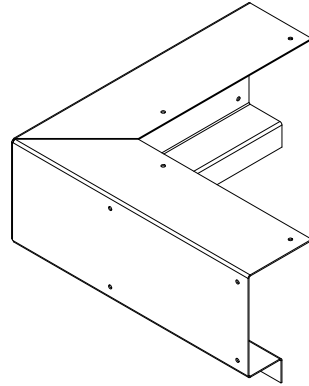
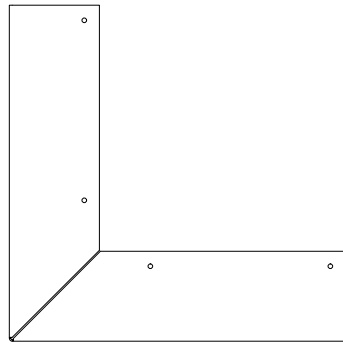

CPS-6-14
SCALE 1/8

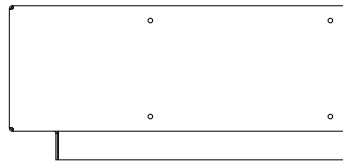

NEDERMAN

TITLE			
MODULAR HOOD INSTALL INSTRUCTIONS			
SIZE		DWG NO	REV
A		MH_Install Guide	2
SCALE	1/8	SHEET 14 OF 20	

2



1

HOOD COMPONENTS CONT.

FPS-6-120

FASCIA PANEL 10 FT. LONG

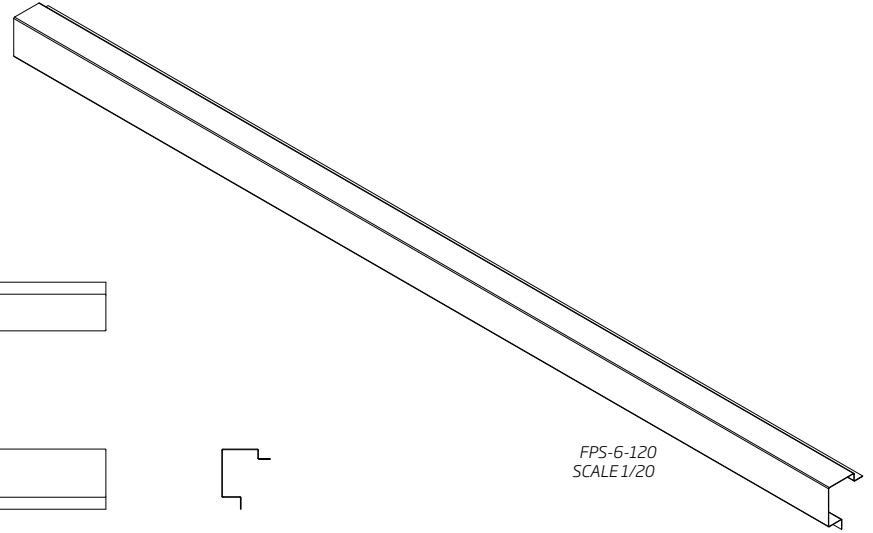

FPS-6-120
SCALE 1/20



B

B

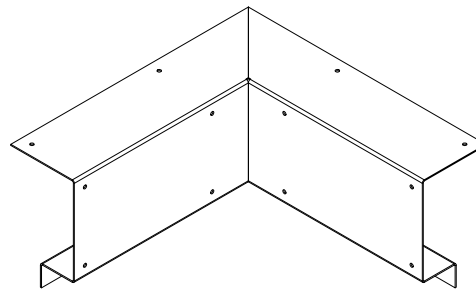
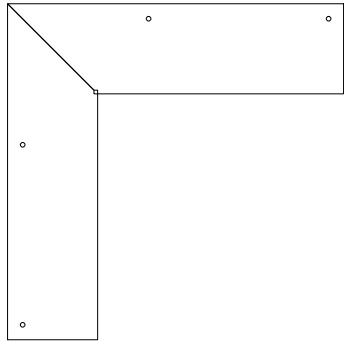

ICS-6-14
SCALE 1/8

ICS-6-14

MODULAR HOOD INSIDE CORNER - 6"X14"

A

A

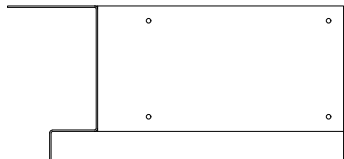

NEDERMAN

TITLE

MODULAR HOOD INSTALL INSTRUCTIONS

SIZE

A

DWG NO

MH_Install Guide

REV

2

SCALE

1/8

SHEET 15 OF 20

2



1

HOOD COMPONENTS CONT.



PG-48-288

POLYGAL 4'W X 24'H

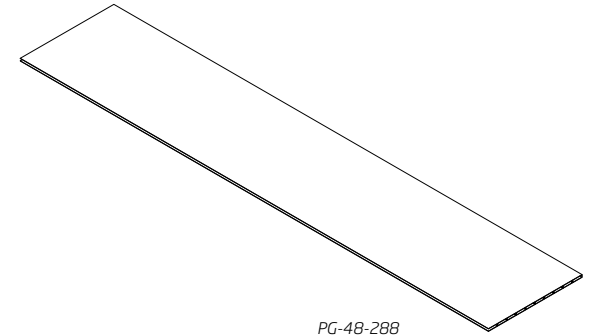

PG-48-288
SCALE 1/29

WC40-48-150

AZTEC RED CURTAIN:
40 MIL, 48" X 150' (FULL ROLL)

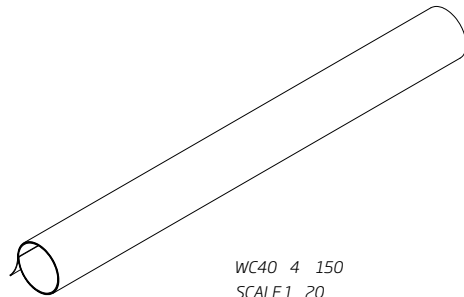

WC40 4 150
SCALE 1 20

JPS-6-36

FASCIA JOINER PANEL

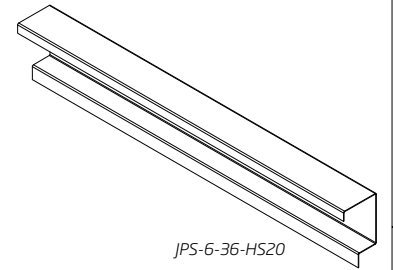

JPS-6-36-HS20
SCALE 1/15

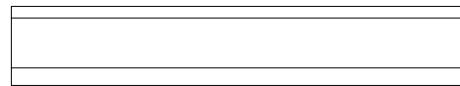

NEDERMAN

TITLE

MODULAR HOOD INSTALL INSTRUCTIONS

SIZE
A

DWG NO

MH_Install Guide

REV
2

SCALE
1/29

SHEET 16 OF 20

HOOD COMPONENTS CONT.



SP-2-2-120

SUPPORT POST WITH FOOT PAD
2" X 2" X 10'

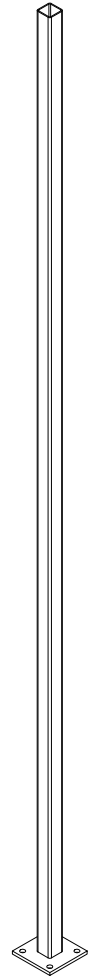
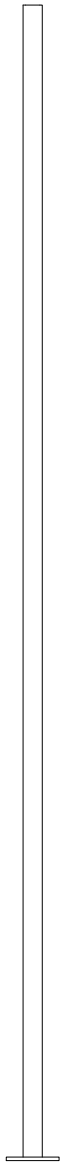

SP-2-2-120
SCALE 1/20

ANG-22-144

SUPPORT ANGLE 12 FT. LONG

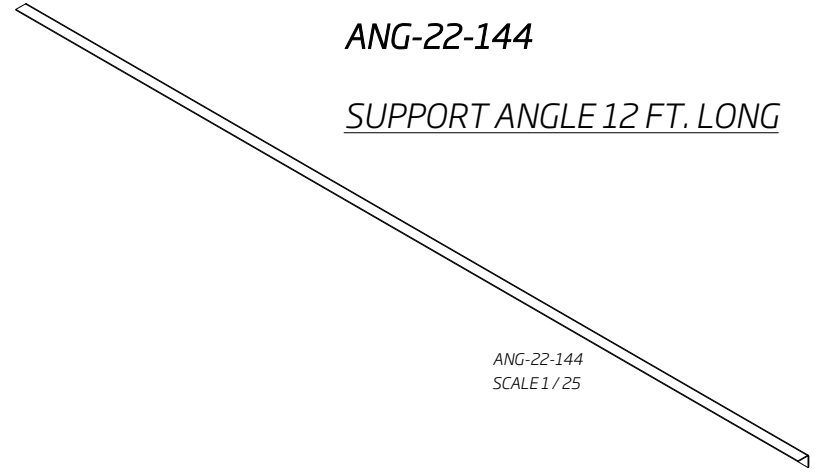

ANG-22-144
SCALE 1/25

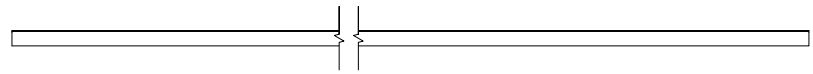

NEDERMAN

TITLE

MODULAR HOOD INSTALL INSTRUCTIONS

SIZE

A

DWG NO

MH_Install Guide

REV

2

SCALE

1/25

SHEET 17 OF 20

2



1

HOOD COMPONENTS CONT.

SR-23-288

SUPPORT RIB 24 FT. LONG

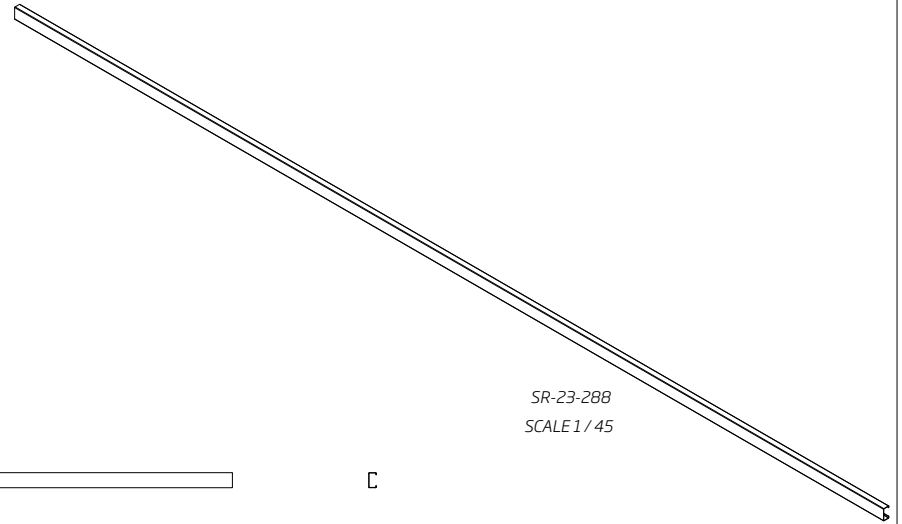

SR-23-288
SCALE 1 / 45



C

B

B

MH-HK

MODULAR HOOD HARDWARE KIT

EACH KIT INCLUDES:

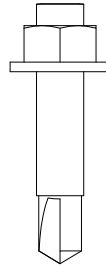
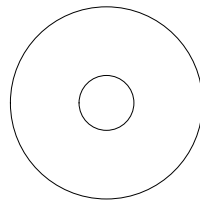
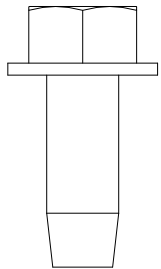
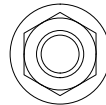
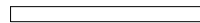
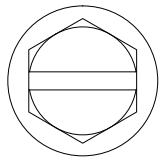

INCLUDED BUT NOT SHOWN:

- (1) 53766 LETTER R DRILL BIT
- (4) NEDERMAN DECAL/LABEL
- INSTRUCTION MANUAL

1132425 3/8"X1" THREADED CUTTING SCREW
SCALE 1/1
QTY 50

1133207 1/4" FENDER WASHER
SCALE: 1/1
QTY 150

1131823 1/4" X1" SDS
SCALE: 1/1
QTY 300

NEDERMAN

TITLE

MODULAR HOOD INSTALL INSTRUCTIONS

SIZE

A

DWG NO

MH_Install Guide

REV

2

SCALE

1 / 45

1

SHEET 18 OF 20

2



A



2



1

BEST PRACTICES

1. WHEN A PIECE OF FASCIA IS CUT, ENSURE THE CUT EDGE IS NOT VISIBLE. ANY CUT EDGE MUST BE HIDDEN IN A CORNER. ONLY FACTORY CUT EDGE FASCIA ARE TO BE JOINED TOGETHER AT A JOINER PANEL.
2. THE DEFLECTOR PLATE NEEDS TO BE INSTALLED 4-6" BELOW THE TOP PLATE WHEN INSTALLING A BAFFLE TO IT.
3. CURTAIN NEEDS TO HANG PAST THE TOP OF THE CELL FENCE LINE BY 4-6" TO ENSURE THERE ARE NO GAPS.
4. CURTAIN NEEDS TO OVERLAP ADJOINING CURTAIN PANEL BY 4-6" TO ENSURE THERE ARE NO GAPS.
5. CURTAIN NEEDS TO BE NOTCHED SO IT CAN BE TACKED INSIDE THE CELL FENCE LINE FOR A CLEAN APPEARANCE. IT MUST BE NOTCHED AROUND OBSTACLES (I.E. SUPPORTS, CABLE TRAYS, WELD WIRE FEEDERS, ETC.) TO ALLOW IT TO LAY FLAT/SMOOTH FOR A PROFESSIONAL LOOK.
6. INSIDE CORNERS MUST BE MITER CUT. (SEE SHEET 4).

B

B



A

A

2



1

NEDERMAN

TITLE			
MODULAR HOOD INSTALL INSTRUCTIONS			
SIZE		DWG NO	REV
A		MH_Install Guide	2
SCALE		SHEET 19 OF 20	

Nederman

The Nederman Group is one of the World's leading suppliers of products and solutions within the environmental technology sector focusing on industrial air filtration and recycling. These products and solutions reduce the environmental impact of industrial production and create safe and clean working environments while boosting production efficiency.

The group's offering covers the design stage through installation, commissioning and servicing with subsidiaries in 29 countries and agents and distributors in over 30 countries.

Nederman is ISO 9001 and 14001 certified and develops and produces in its own manufacturing and assembly facilities in Europe, North America and Asia.

Nederman Service Capabilities

Nederman has certified service partners trained extensively in servicing our machinery. Make sure to choose a certified technician to service your Nederman equipment as they have the correct tools and knowledge to solve any machinery issues and improve its performance. Be sure to ask if your technician is certified by Nederman.

Our services for dust collection systems are customized to your particular needs. We work with you to understand your needs, then develop a program to meet your specific needs. Our services include: *(not all services available in all locations)*

- Bag Change-outs
- Bag Selection Recommendations
- Collector Re-builds
- Dye Testing for Leakage
- Electrical Tests - Current, Voltage
- Emergency Call-outs
- Filter Media Analysis
- Mechanical Survey and Repair
- Multi-year Contracts
- New Collector Start-up Service
- On-going Technical Support
- Preventative Maintenance Programs
- Repair and Replace
Gauges/Timers/Valves
- Stack Emission Testing
- Training Programs
- Troubleshooting / Auditing
- Velocity, Pressure and Temperature Tests
- Written Service Report

Customer Service and Technical Support

Nederman Corporation USA
4404-A Chesapeake Drive
Charlotte, NC 28216
336-821-0800

www.nederman.com